

EC2380-AB (USB2380 Evaluation Board)

The EC2380-AB is evaluation board for USB 2380-AB, an ExpressCard (PCI Express Gen 1) to USB 2.0 Hi-Speed Peripheral Controller. It features one ExpressCard (PCI Express Gen 1 x1) port and one USB 2.0 Hi-Speed client port. The EC2380-AB provides a matching bandwidth at 2.5GT/s between the PCI Express Gen 1 bus and the USB 2.0 Hi-Speed bus. The controller can easily add a USB 2.0 client port to an existing system such as laptop PC with ExpressCard slot, as well as convert an existing PCI Express function (endpoint) to a USB 2.0 product. The EC2380-AB can configure the ExpressCard as one x1 upstream port or one x1 downstream port. The flexibility allows different system configurations to achieve the maximum performance of the product.



Specification:

USB 2.0 Client Interface

- ◆ USB 2.0 Specification Compliant
- ◆ 1 upstream port
- ◆ Supports Hi-Speed, Full-Speed modes
- ◆ Four Descriptor-based DMA channels for automatic data transfers
- ◆ Supports USB Duet® Technology
- ◆ USB Auto-Enumeration Technology
- ◆ Support for Bulk, Isochronous, and Interrupt Endpoints
- ◆ USB 2.0 link power management states: L0, L1, L2
- ◆ Micro B Receptacle connector

ExpressCard (PCI Express) Interface

- PCI Express Gen 1 (2.5Gbps)
- Electrical Compliance to PCI Express Base Specification r2.0
- PCIe interface and integrated root complex provides two configurations:
 - one x1 upstream port
- PCI Express Power Management
 - All link power management states: L0, L0s, L1, L2/L3 Ready, and L3
 - Device states: D0 and D3(hot & cold)
 - Vaux, Wake#, Beacon support
- 256 byte maximum payload size
- ExpressCard 1.0 compliance

Note: Software development is required. To obtain RDK, please contact PLX Sales Representative or Distributor;
<http://www.plxtech.com/about/contacts>

As a New manufacturer of quality computer connectivity products since 2009/Mar, BPLUS technology brings to market a broad range of upgrade products. These products bridge the connection between Desktop/Notebook systems and external peripherals.



Professional I/O adapter provider

Bplus Technology Co., Ltd.

Address: 9F-1, NO. 88, ZHOU-TZYY ST.,
NEI-HU, TAIPEI, TAIWAN, R.O.C
TEL: +886-2-7736-0128
FAX: +886-2-7736-0126
Email: sales@bplus.com.tw
<http://www.Bplus.com.tw>

Applications

Target applications for the **EC2380-AB** adapter as a PCI Express endpoint include PCs, servers, docking stations, printers, and PCI Express embedded systems.

EC2380-AB application



Add a USB 2.0 Client Port to ExpressCard-Based Systems

The EC2380-AB can be used to easily add a USB 2.0 client port to any ExpressCard based embedded system.

EC2380-AB Contents



EC2380-AB
(ExpressCard to USB 2.0 Adapter) x1



USB 2.0 A Male to Micro B Cable x1



SPB087
(ExpressCard 34 to 54 Bracket) x1

As a New manufacturer of quality computer connectivity products since 2009/Mar, BPLUS technology brings to market a broad range of upgrade products. These products bridge the connection between Desktop/Notebook systems and external peripherals.



Professional I/O adapter provider

Bplus Technology Co., Ltd.

Address: 9F-1, NO. 88, ZHOU-TZYY ST.,
NEI-HU, TAIPEI, TAIWAN, R.O.C
TEL: +886-2-7736-0128
FAX: +886-2-7736-0126
Email: sales@bplus.com.tw
http://www.Bplus.com.tw

Option

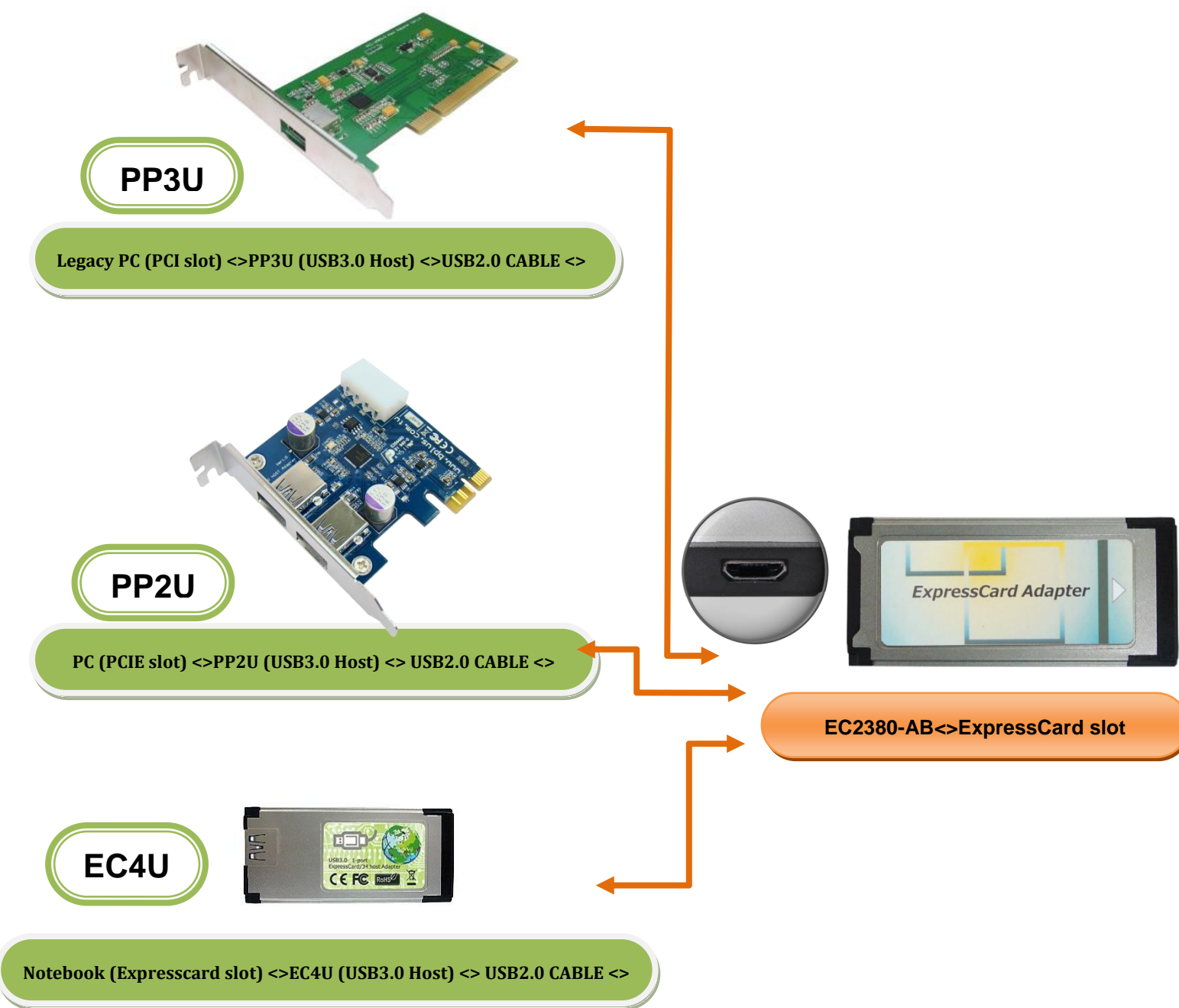

As a New manufacturer of quality computer connectivity products since 2009/Mar, BPLUS technology brings to market a broad range of upgrade products. These products bridge the connection between Desktop/Notebook systems and external peripherals.



Professional I/O adapter provider
Bplus Technology Co., Ltd.

Address: 9F-1, NO. 88, ZHOU-TZYY ST.,
NEI-HU, TAIPEI, TAIWAN, R.O.C
TEL: +886-2-7736-0128
FAX: +886-2-7736-0126
Email: sales@bplus.com.tw
<http://www.Bplus.com.tw>