

USBMS-E (Wireless USB Mini Card Adapter ver1.2)

The USBMS-E adapter is designed for desktop/Laptop PCs that convert 3G wireless Mini-Card to USB port.

You can insert your USB type minicard such as GSM, HSPA(3.5G), GPS, LTE cards to this adapter then plug to USB port through USB cable.

Standard SIM card Push Push connector is provided.

Function:

- ◆ USB mini type-B connection to desktop or notebook PC
- ◆ Supports system bus interface: USB.
- ◆ Supports USB interface of Mini-Cards such as 2G GSM, GPRS, 3G,CDMA, WLAN,WLAN, HSPA MODEM , GPS, 4G WiMAX, LTE, Mini Card to desktop PC.
- ◆ Add ACCESS LED, POWER LED
- ◆ Support SIM card Push Push connector.
- ◆ Support U.FL/IPX to SMA pigtail Wifi RF cable adapter
- ◆ (Option) 800/1800 MHz Duck Antenna
- ◆ (Option) 900/2100 MHz Duck Antenna
- ◆ (Option) 2.4GHz MHz 2.15dBi Rubber Duck Antenna
- ◆ (Option) 2.4/5.8GHz Rubber Duck Antenna
- ◆ (Option) 5.8GHz 5dBi Rubber Duck Antenna
- ◆ (Option) 2.3GHz 2.15dBi Rubber Duck Antenna
- ◆ (Option) 2.5GHz 2 dBi Rubber Duck Antenna
- ◆ (Option) 3.5GHz 2.5dBi Rubber Duck Antenna

Specification:

- ◆ PCI Express Mini Card to USB adapter.
- ◆ PCI Express Mini Card Electromechanical Specification Revision 1.2
- ◆ Universal Serial Bus Specification Revision 2.0
- ◆ Full / Half -Mini Card dimension.
- ◆ SIM Connector for CDMA HSDPA/HSUPA,UMTS, GSM, GPRS, EDGE

U.fl / IPX to SMA female pigtail for wifi RF cable adapter



U.fl / IPX to RP-SMA female pigtail for wifi RF cable adapter

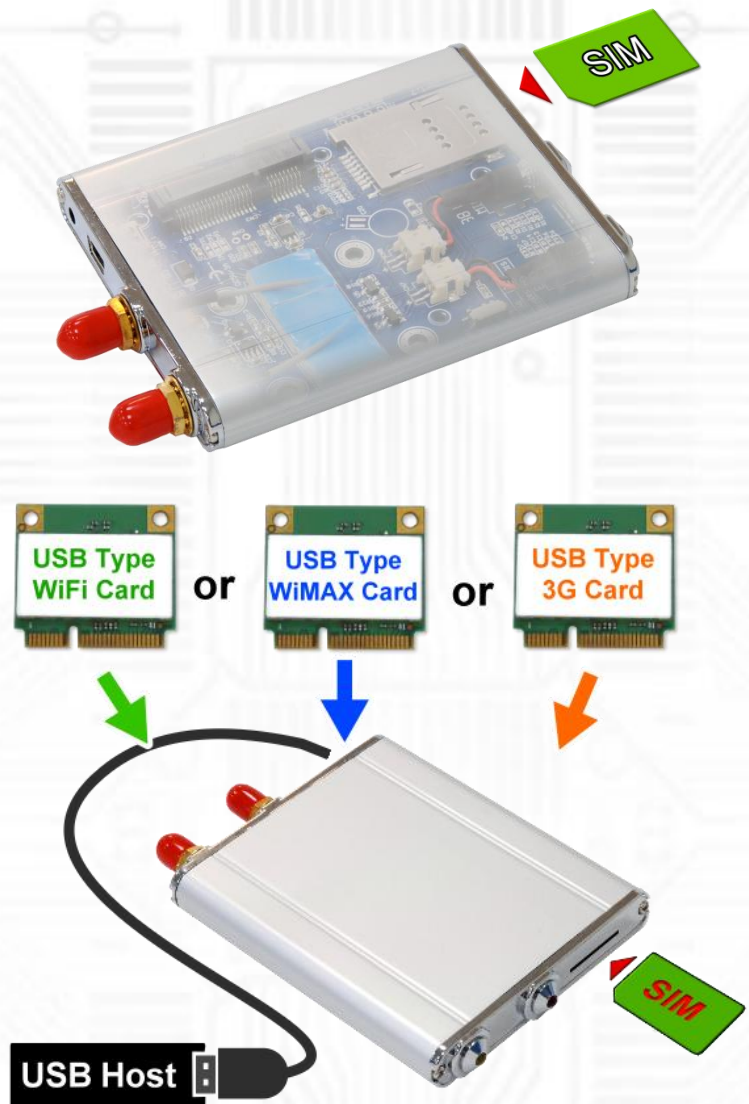
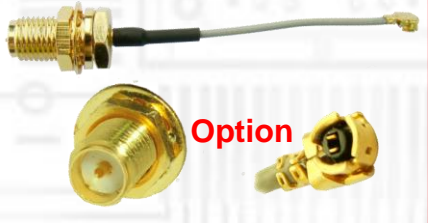

SIM card Push Push connector

As a New manufacturer of quality computer connectivity products since 2009/Mar, BPLUS technology brings to market a broad range of upgrade products. These products bridge the connection between Desktop/Notebook systems and external peripherals.



Professional I/O adapter provider

Bplus Technology Co., Ltd.

Address: 9F-1, NO.88, ZHOU-TZYY ST., NEI-HU, TAIPEI, TAIWAN, R.O.C
 TEL: +886-2-7736-0128
 FAX: +886-2-7736-0126
 Email: sales@bplus.com.tw
 http://www.Bplus.com.tw

USBMS-E Package Contents

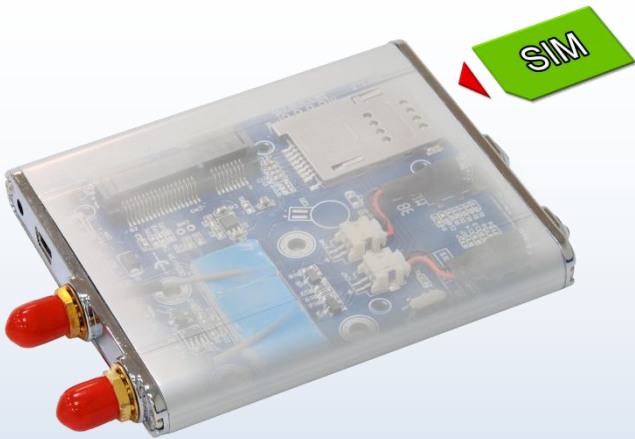

USBMS-E
(Wireless USB Mini Card Adapter ver1.2) x1
with SMA IPX cable x2



USB-Y-Line-2.0
(USB 2.0 Y-Line cable) x1



P25AMTDC60
(USB A Male to DC Power Cable) x1

U.fl / IPX to SMA female pigtail for wifi RF cable adapter

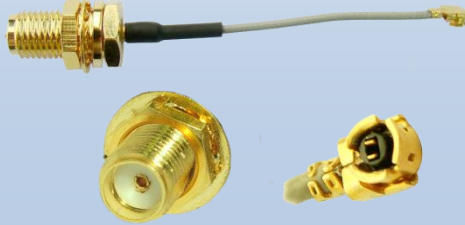

Screwdriver x1



Screw x2

As a New manufacturer of quality computer connectivity products since 2009/Mar, BPLUS technology brings to market a broad range of upgrade products. These products bridge the connection between Desktop/Notebook systems and external peripherals.



Professional I/O adapter provider

Bplus Technology Co., Ltd.

Address: 9F-1, NO. 88, ZHOU-TZYY ST.,
NEI-HU, TAIPEI, TAIWAN, R.O.C
TEL: +886-2-7736-0128
FAX: +886-2-7736-0126
Email: sales@bplus.com.tw
<http://www.Bplus.com.tw>